

# Instruction of IMEX concealed basin faucet GLT023/ETNA

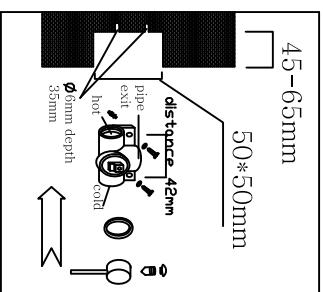

- 1) check all spare parts
- 1 pipe
- 2 body to handle
- 3 handle
- 4 cover plate
- 5 body to pipe
- 7 spare part bag

- 2) Dig hole for body to handle
- 2.1 Hole size 50\*50mm, depth from 45 to 65mm;
- 2.2 Dig two 6mm holes with 42mm distance
- 2.3 Assemble spare parts as picture shows

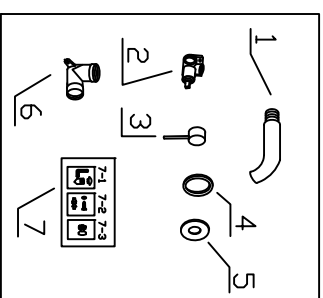
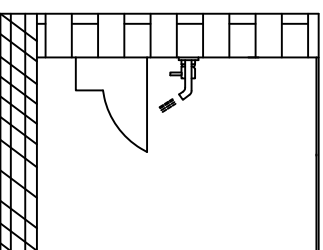
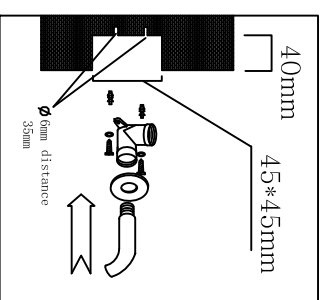

- 3) Dig hole for body to pipe
- 3.1 Hole size 45\*45mm, depth 40mm;
- 3.2 Dig two holes 6mm distance 35mm
- 3.3 Assemble spare parts as picture shows

- 4) Connect inside pipe and test for leak checking